

# Thrust ball bearings.

Inch series

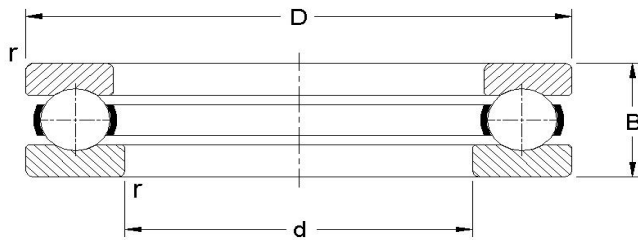

Dimensions				Load ratings		Designation	M
d mm	D	B	r	Dynamic C N	Static Co		
9.525	25.4	13.4937	0.8	8900	8900	<b>W 3/8</b>	*
11.1125	32.5437	15.875	0.8	14900	15800	<b>W 7/16</b>	
12.7	32.5437	15.875	0.8	19200	20000	<b>W 1/2</b>	*
14.2875	35.7187	15.875	0.8	20000	22500	<b>W 9/16</b>	
15.875	35.7187	15.875	0.8	20000	22500	<b>W 5/8</b>	
19.05	38.894	15.875	0.8	18200	23700	<b>W 3/4</b>	
	39.6875	18.2562	0.8	20800	25000	<b>MT 3/4</b>	*
22.225	42.0687	15.875	0.8	19600	27600	<b>W 7/8</b>	
	46.0375	19.05	0.8	24800	30800	<b>MT 7/8</b>	*
25.4	45.244	15.875	1.6	19300	27600	<b>W 1</b>	
	50.8	19.05	1.6	27300	37000	<b>MT 1</b>	*
28.575	48.41875	15.875	1.6	20500	31600	<b>W 1.1/8</b>	
	57.15	22.225	1.6	34000	44400	<b>MT 1.1/8</b>	*
31.75	52.3875	12.7		4470	8900	<b>EW 1.1/4</b>	
	53.1812	18.2562	1.6	23100	35000	<b>W 1.1/4</b>	
	63.5	25.4	1.6	45600	60500	<b>MT 1.1/4</b>	*
34.925	55.5625	12.7		4360	8900	<b>EW 1.3/8</b>	
	56.3562	18.2562	1.6	22700	35000	<b>W 1.3/8</b>	
38.1	58.7375	12.7		4620	10000	<b>EW 1.1/2</b>	
	59.533	18.2562	1.6	24300	40000	<b>W 1.1/2</b>	
	73.025	28.575	1.6	57300	79000	<b>MT 1.1/2</b>	*
41.275	61.9125	12.7		4540	10000	<b>EW 1.5/8</b>	
	62.7062	18.2562	1.6	23900	40000	<b>W 1.5/8</b>	*
44.475	66.675	15.875		5700	12700	<b>EW 1.3/4</b>	
	68.2625	19.05	1.6	35400	59500	<b>W 1.3/4</b>	
	84.1375	31.75	1.6	84500	122000	<b>MT 1.3/4</b>	*
47.625	69.85	15.875		6000	14100	<b>EW 1.7/8</b>	
	71.4375	19.05	1.6	31000	55500	<b>W 1.7/8</b>	

# Thrust ball bearings.

Inch series

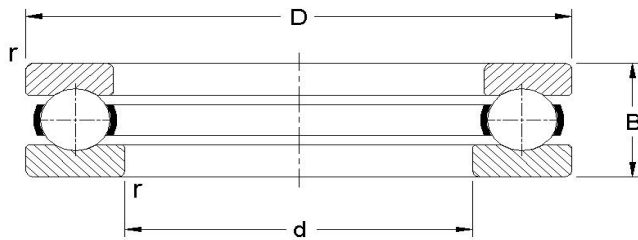

Dimensions			Load ratings		Designation	M	
d mm	D	B	Dynamic C N	Static Co			
50.8	73.025	15.875		5900	14100	<b>EW 2</b>	
	77.787	17.4625	1.6	25900	50000	<b>XW 2</b>	
	75.408	19.05	2.4	33600	65000	<b>W 2</b>	
	93.6625	34.925	2.4	96000	148000	<b>MT 2</b>	*
53.975	80.9625	17.4625	1.6	25500	50000	<b>XW 2.1/8</b>	*
	81.7562	22.225	2.4	43700	80000	<b>W 2.1/8</b>	*
57.15	79.375	15.875		6100	15500	<b>EW 2.1/4</b>	
	84.1375	17.4625	1.6	26800	55000	<b>XW 2.1/4</b>	*
	84.9312	22.225	2.4	43100	80000	<b>W 2.1/4</b>	*
	107.95	42.8625	2.4	128000	195000	<b>MT 2.1/4</b>	*
60.325	87.3125	17.4625	1.6	26500	55000	<b>XW 2.3/8</b>	*
	91.2812	25.4	2.4	58000	109000	<b>W 2.3/8</b>	
63.5	90.4875	17.4625	1.6	27700	60000	<b>XW 2.1/2</b>	*
	94.4562	25.4	2.4	57500	109000	<b>W 2.1/2</b>	*
	120.65	50.8	2.4	160000	242000	<b>MT 2.1/2</b>	*
66.675	95.25	19.05	1.6	32100	68000	<b>XW 2.5/8</b>	*
	97.6312	25.4	2.4	57000	109000	<b>W 2.5/8</b>	*
69.85	98.425	19.05	1.6	33700	74000	<b>XW 2.3/4</b>	*
	102.3973	25.4	2.4	56500	109000	<b>W 2.3/4</b>	*
	127	50.8	2.4	163200	290000	<b>MT 2.3/4</b>	*
73.025	101.6	19.05	1.6	35100	80000	<b>XW 2.7/8</b>	*
	105.5687	25.4	2.4	64000	125000	<b>W 2.7/8</b>	*
76.2	104.775	19.05	1.6	34800	80000	<b>XW 3</b>	*
	111.125	28.575	3.2	72500	142000	<b>W 3</b>	*
	142.875	57.15	3.2	226000	379000	<b>MT 3</b>	*
79.375	107.95	19.05	1.6	34800	84000	<b>XW 3.1/8</b>	*
	114.3	28.575	3.2	87000	178000	<b>W 3.1/8</b>	*
82.55	111.125	19.05	1.6	35800	86500	<b>XW 3.1/4</b>	*
	122.2375	31.75	3.2	90500	180000	<b>W 3.1/4</b>	*
85.725	125.4125	31.75	3.2	89500	180000	<b>W 3.3/8</b>	*

# Thrust ball bearings.

Inch series

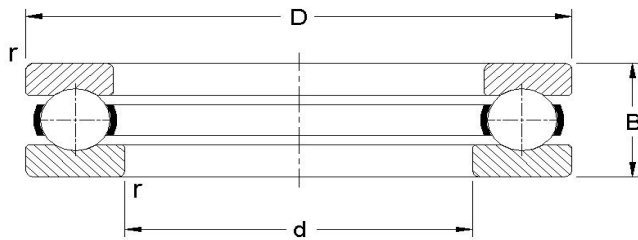

Dimensions			Load ratings		Designation	M	
d mm	D	B	Dynamic C N	Static Co			
88.9	117.475	19.05	1.6	36800	92500	<b>XW 3.1/2</b>	*
	128.5875	31.75	3.2	88500	180000	<b>W 3.1/2</b>	*
	163.5125	63.5	3.2	274000	490000	<b>MT 3.1/2</b>	*
92.075	131.7625	31.75	3.2	94500	200000	<b>W 3.5/8</b>	*
95.25	123.825	19.05	1.6	37700	98500	<b>XW 3.3/4</b>	*
	134.9375	31.75	3.2	93500	200000	<b>W 3.3/4</b>	*
98.425	144.4625	34.925	3.2	107000	222000	<b>W 3.7/8</b>	*
101.6	133.35	22.225	2.4	49500	124000	<b>XW 4</b>	*
	147.6375	34.925	3.2	122000	258000	<b>W 4</b>	*
	184.15	71.4375	3.2	305000	592000	<b>MT 4</b>	*
107.95	160.3375	44.45	3.2	153000	320000	<b>W 4.1/4</b>	*
114.3	146.05	25.4	2.4	50500	133000	<b>XW 4.1/2</b>	*
	166.6875	44.45	4.8	150000	320000	<b>W 4.1/2</b>	*
	212.725	85.725	4.8	398000	853000	<b>MT 4.1/2</b>	*
120.65	179.3875	50.8	4.8	203000	435000	<b>W 4.3/4</b>	
127	165.1	28.575	2.4	67000	181000	<b>XW 5</b>	*
	185.738	50.8	4.8	201000	435000	<b>W 5</b>	*
	241.3	101.6	4.8	473000	1064000	<b>MT 5</b>	*
139.7	177.8	28.575	2.4	68500	193000	<b>XW 5.1/2</b>	*
	204.788	55.5625	4.8	258000	568000	<b>W 5.1/2</b>	*
	263.525	107.95	4.8	486000	1110000	<b>MT 5.1/2</b>	*
152.4	193.675	31.75	3.2	88000	253000	<b>XW 6</b>	*
	220.662	60.325	4.8	280000	642000	<b>W 6</b>	*
	282.575	114.3	4.8	564000	1390000	<b>MT 6</b>	*
165.1	206.375	31.75	3.2	90000	268000	<b>XW 6.1/2</b>	*
	238.9188	63.5	6.35	312000	759000	<b>W 6.1/2</b>	*
177.8	222.25	34.925	3.2	113000	340000	<b>XW 7</b>	*
	257.175	66.675	6.35	346000	891000	<b>W 7</b>	*
	323.85	127	6.35	619000	1599000	<b>MT 7</b>	*

# Thrust ball bearings.

Inch series

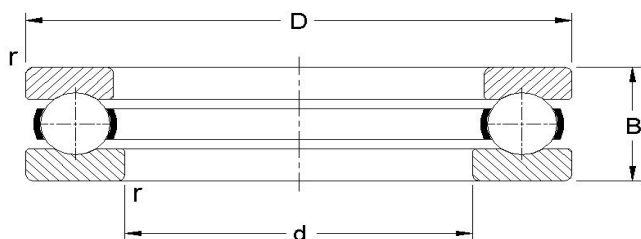

Dimensions			Load ratings		Designation	M	
d	D	B	Dynamic	Static			
mm			C	Co			
			N				
190.5	234.95	34.925	3.2	115000	360000	<b>XW 7.1/2</b>	*
	276.225	69.85	6.35	310000	799000	<b>W 7.1/2</b>	*
203.2	254	38.1	3.2	135000	419000	<b>XW 8</b>	*
	295.275	76.2	6.35	339000	888000	<b>W 8</b>	*
	365.125	142.875	6.35	713000	1974000	<b>MT 8</b>	*
215.9	266.7	38.1	3.2	138000	444000	<b>XW 8.1/2</b>	*
228.6	285.75	47.625	4.8	191000	604000	<b>XW 9</b>	*
	333.375	88.9	6.35	445000	1277000	<b>W 9</b>	*
	422.275	171.45	6.35	931000	2840000	<b>MT 9</b>	*
241.3	298.45	47.625	4.8	196000	640000	<b>XW 9.1/2</b>	*
254	317.5	53.975	4.8	246000	770000	<b>XW 10</b>	*
	371.475	101.6	7.9	561000	1740000	<b>W 10</b>	*
266.7	330.2	53.975	4.8	253000	823000	<b>XW 10.1/2</b>	*
279.4	349.25	60.325	4.8	276000	885000	<b>XW 11</b>	*
	403.225	107.95	7.9	613000	2000000	<b>W 11</b>	*
292.1	361.95	60.325	4.8	284000	943000	<b>XW 11.1/2</b>	*
304.8	381	63.5	4.8	307000	1010000	<b>XW 12</b>	*
	441.325	114.3	7.9	667000	2274000	<b>W 12</b>	*
317.5	393.7	66.675	6.35	317000	1072000	<b>XW 12.1/2</b>	*
330.2	412.75	69.85	6.35	333000	1140000	<b>XW 13</b>	*
342.9	425.45	73.025	6.35	363000	1280000	<b>XW 13.1/2</b>	*
355.6	444.5	76.2	6.35	376000	1330000	<b>XW 14</b>	*
368.3	457.2	79.375	6.35	407000	1480000	<b>XW 14.1/2</b>	*
381	476.25	82.55	6.35	419000	1570000	<b>XW 15</b>	*
393.7	488.95	85.725	6.35	434000	1630000	<b>XW 15.1/2</b>	*
406.4	508	88.9	6.35	464000	1790000	<b>XW 16</b>	*
419.1	520.7	92.075	6.35	481000	1910000	<b>XW 16.1/2</b>	*

## Thrust ball bearings.

Inch series

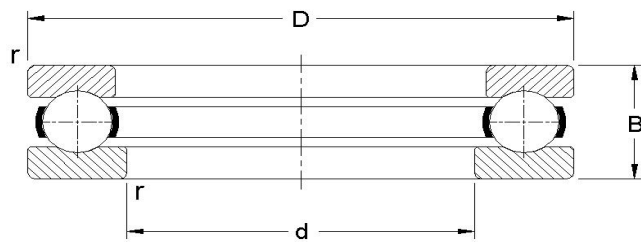

Dimensions				Load ratings		Designation	M
d mm	D	B	r	Dynamic C N	Static Co		
431.8	539.75	95.25	6.35	514000	2081000	<b>XW 17</b>	*
444.5	552.45	98.425	7.9	548000	2270000	<b>XW 17.1/2</b>	*
457.2	571.5	101.6	7.9	543000	2270000	<b>XW 18</b>	*