

# Thrust ball bearings

Full compliment

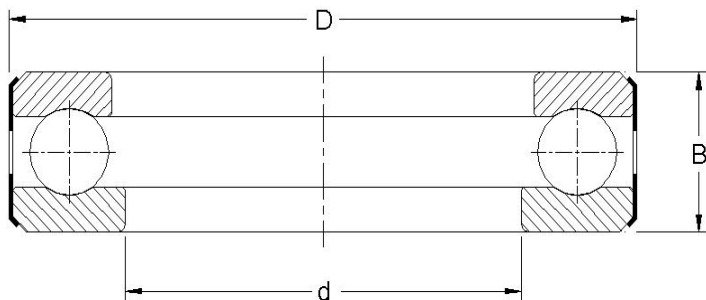

Dimensions			Load ratings		Designation
d mm	D	B	Dynamic C N	Static Co	
12.7	30.9626	14.2875	14500	15400	<b>D 1</b>
15.875	34.1313	14.2875	15500	20300	<b>D 3</b>
19.05	37.3063	14.2875	16000	22800	<b>D 5</b>
22.225	46.83125	15.875	24000	40300	<b>D 7</b>
25.4	50.0063	15.875	25100	43200	<b>D 9</b>
28.575	53.1876	15.875	25800	47000	<b>D 11</b>
31.75	59.5313	15.875	27000	54400	<b>D 13</b>
34.925	62.706	15.875	27500	58400	<b>D 15</b>
38.1	65.8813	15.875	28300	66700	<b>D 17</b>
44.45	78.5813	20.6375	39300	96000	<b>D 21</b>
50.8	84.9313	20.6375	40800	107000	<b>D 25</b>
57.15	94.4626	20.6375	42000	118000	<b>D 29</b>
61.9252	97.6313	20.6375	43200	122500	<b>D 32</b>
63.5	100.8063	20.6375	43200	129000	<b>D 33</b>
69.85	113.5126	25.4	68500	190000	<b>D 37</b>
71.4502	113.5126	25.4	68500	190000	<b>D 38</b>
76.2	116.6876	25.4	68500	190000	<b>D 39.1/2</b>
76.2	119.8626	25.4	70500	198200	<b>D 40</b>
82.55	126.2126	25.4	72600	218000	<b>D 41</b>