

# Thrust ball bearings

Metric series

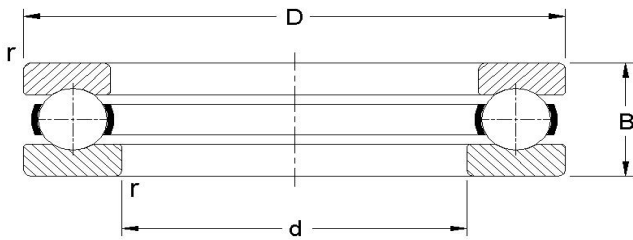

d mm	Dimensions			Load ratings		Designation
	D	B	r	Dynamic C N	Static Co	
10	24	9	0.3	9950	14000	<b>51100</b>
	26	11	0.6	12700	17000	<b>51200</b>
12	26	9	0.3	10400	15300	<b>51101</b>
	28	11	0.6	13300	19000	<b>51201</b>
15	28	9	0.3	9360	14000	<b>51102</b>
	32	12	0.6	16500	25000	<b>51202</b>
17	30	9	0.3	9750	15300	<b>51103</b>
	35	12	0.6	17200	27500	<b>51203</b>
20	35	10	0.3	12700	20800	<b>51104</b>
	40	14	0.6	22500	37500	<b>51204</b>
25	42	11	0.6	15900	29000	<b>51105</b>
	47	15	0.6	27600	50000	<b>51205</b>
	52	18	1	34500	55000	<b>51305</b>
	52	24	1	55300	90000	<b>51405</b>
30	47	11	0.6	16800	33500	<b>51106</b>
	52	16	0.6	25500	47500	<b>51206</b>
	60	21	1	37700	65500	<b>51306</b>
	70	28	1	72800	125000	<b>51406</b>
35	52	12	0.6	17400	37500	<b>51107</b>
	62	18	1	35100	67000	<b>51207</b>
	68	24	1	49400	88000	<b>51307</b>
	80	32	1.1	87100	156000	<b>51407</b>
40	60	13	0.6	23400	50000	<b>51108</b>
	68	19	1	46800	98000	<b>51208</b>
40	78	26	1	61800	112000	<b>51308</b>
	90	36	1.1	112000	204000	<b>51408</b>
45	65	14	0.6	24200	57000	<b>51109</b>
	73	20	1	39000	80000	<b>51209</b>
	85	28	1	76100	140000	<b>51309</b>
	100	39	1.1	130000	240000	<b>51409</b>
50	70	14	0.6	25500	63000	<b>51110</b>

# Thrust ball bearings

Metric series

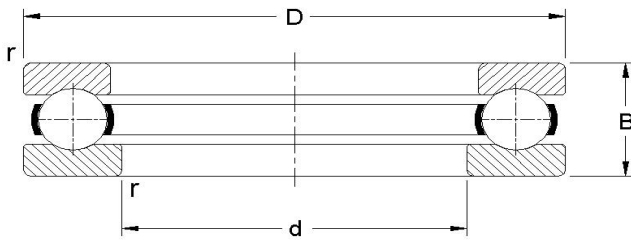

d mm	Dimensions			Load ratings		Designation
	D	B	r	Dynamic C N	Static Co	
	78	22	1	49400	106000	<b>51210</b>
	95	31	1.1	88400	173000	<b>51310</b>
	110	43	1.5	159000	310000	<b>51410</b>
55	78	16	0.6	30700	78000	<b>51111</b>
	90	25	1	61800	134000	<b>51211</b>
	105	35	1.1	104000	208000	<b>51311</b>
	120	48	1.5	178000	360000	<b>51411</b>
60	85	17	1	35800	90000	<b>51112</b>
	95	26	1	62400	140000	<b>51212</b>
	110	35	1.1	101000	208000	<b>51312</b>
	130	51	1.5	199000	400000	<b>51412</b>
65	90	18	1	37100	98000	<b>51113</b>
	100	27	1	63700	150000	<b>51213</b>
	115	36	1.1	106000	220000	<b>51313</b>
	140	56	2	216000	450000	<b>51413</b>
70	95	18	1	37700	104000	<b>51114</b>
	105	27	1	65000	160000	<b>51214</b>
	125	40	1.1	135000	300000	<b>51314</b>
	150	60	2	234000	500000	<b>51414</b>
75	100	19	1	44200	137000	<b>51115</b>
	110	27	1	67600	170000	<b>51215</b>
	135	44	1.5	163000	360000	<b>51315</b>
	160	65	2	251000	560000	<b>51415</b>
80	105	19	1	44900	140000	<b>51116</b>
	115	28	1	76100	190000	<b>51216</b>
	140	44	1.5	159000	360000	<b>51316</b>
	170	68	2.1	270000	620000	<b>51416</b>
85	110	19	1	46200	150000	<b>51117</b>
	125	31	1	97500	250000	<b>51217</b>
	150	49	1.5	190000	425000	<b>51317</b>
	180	72	2.1	286000	680000	<b>51417</b>
90	120	22	1	59200	190000	<b>51118</b>

# Thrust ball bearings

Metric series

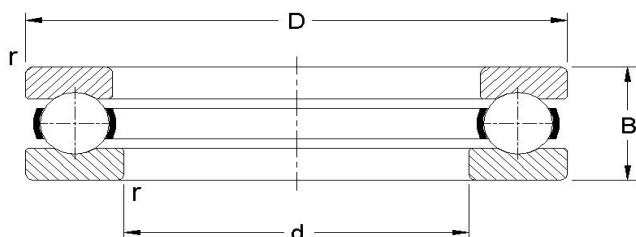

d mm	Dimensions			Load ratings		Designation
	D	B	r	Dynamic C N	Static Co	
	135	35	1.1	119000	300000	<b>51218</b>
	155	50	1.5	195000	465000	<b>51318</b>
	190	77	2.1	307000	750000	<b>51418</b>
100	135	25	1	85200	270000	<b>51120</b>
	150	38	1.1	124000	320000	<b>51220</b>
	170	55	1.5	229000	560000	<b>51320</b>
	210	85	3	371000	965000	<b>51420</b>
110	145	25	1	87100	290000	<b>51122</b>
	160	38	1.1	130000	360000	<b>51222</b>
	190	63	2	276000	720000	<b>51322</b>
	230	95	3	410000	1140000	<b>51422</b>
130	170	30	1	111000	390000	<b>51126</b>
	190	45	1.5	186000	540000	<b>51226</b>
130	225	75	2.1	358000	1060000	<b>51326</b>
	270	110	4	520000	1600000	<b>51426</b>
140	180	31	1	111000	400000	<b>51128</b>
	200	46	1.5	190000	570000	<b>51228</b>
	240	80	2.1	397000	1220000	<b>51328</b>
	280	112	4	520000	1600000	<b>51428</b>
150	190	31	1	111000	400000	<b>51130</b>
	215	50	1.5	238000	735000	<b>51230</b>
	250	80	2.1	410000	1290000	<b>51330</b>
	300	120	4	559000	1800000	<b>51430</b>
160	200	31	1	112000	425000	<b>51132</b>
	225	51	1.5	242000	780000	<b>51232</b>
	270	87	3	449000	1500000	<b>51332</b>
170	215	34	1.1	133000	500000	<b>51134</b>
	240	55	1.5	286000	930000	<b>51234</b>
	280	87	3	468000	1600000	<b>51334</b>
180	225	34	1.1	135000	530000	<b>51136</b>
	250	56	1.5	296000	1000000	<b>51236</b>
	300	95	3	520000	1830000	<b>51336</b>

# Thrust ball bearings

Metric series

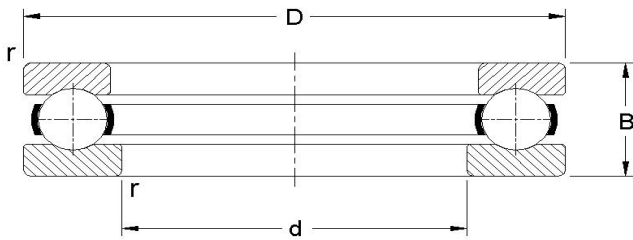

d mm	Dimensions			Load ratings		Designation
	D	B	r	Dynamic C N	Static Co	
190	240	37	1.1	172000	655000	<b>51138</b>
	270	62	2	332000	1160000	<b>51238</b>
	320	105	4	600000	2200000	<b>51338</b>
200	250	37	1.1	168000	655000	<b>51140</b>
	280	62	2	338000	1220000	<b>51240</b>
	340	110	4	624000	2400000	<b>51340</b>
220	270	37	1.1	178000	735000	<b>51144</b>
	300	63	2	351000	1320000	<b>51244</b>
240	300	45	1.5	234000	965000	<b>51148</b>
	340	78	2.1	462000	1860000	<b>51248</b>
260	320	45	1.5	238000	1020000	<b>51152</b>
	360	79	2.1	475000	2000000	<b>51252</b>
280	350	53	1.5	319000	1340000	<b>51156</b>
	380	80	2.1	494000	2160000	<b>51256</b>
300	380	62	2	364000	1600000	<b>51160</b>
	420	95	3	605000	2750000	<b>51260</b>
320	400	63	2	371000	1700000	<b>51164</b>
	440	95	3	572000	2700000	<b>51264</b>
340	420	64	2	377000	1800000	<b>51168</b>
	460	96	3	605000	2900000	<b>51268</b>
360	440	65	2	390000	1900000	<b>51172</b>
	500	110	4	741000	3800000	<b>51272</b>
380	460	65	2	430000	2240000	<b>51176</b>
400	480	65	2	440000	2320000	<b>51180</b>